



AD SOYAD: NO: PUAN:

KARABÜK ÜNİVERSİTESİ, MÜHENDİSLİK FAKÜLTESİ, YAZ OKULU, TEKNİK RESİM, VİZE SINAVI, 02.08.2015

Çizimlerde çizgilerin hiza ve mesafelerini koruyunuz. Elle, cetvelle, kimlik kenarı vb ile çizebilirsiniz. Süre net 45 dakikadır. Çizimleri süresi içinde tamamlamak puanlamaya dahildir. Sınavda soru sormayınız. Birbirinizden malzeme alışverişinde bulunmayınız. Kağıtlarda sıra numarası vardır. Size ait bir hata yakınınızdaki kağıtlarda çıkarsa ikiside kopya işlemi görecektir. Kağıtlarınızı saklayın, Başarılar... İ.Çayıroğlu

1. Aşağıdaki şekillerin 3 görünüşlerini verilen boşluklara ızgarayı kullanarak çiziniz. Ölçülendirme yapmayınız. Çizgileriniz düzgün ve net olsun. Çizgi kalınlıklarına ve hizalara dikkat ediniz (40p).

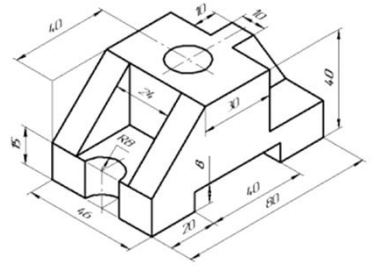
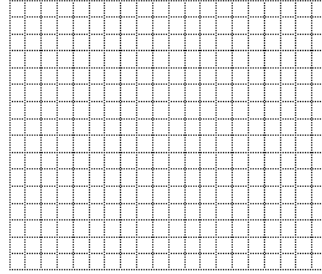
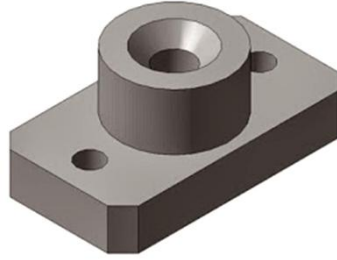
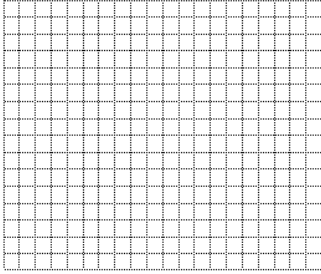
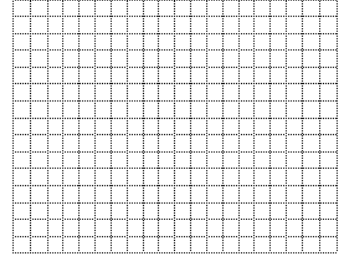
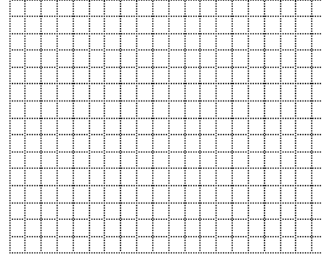
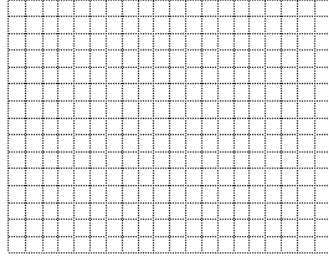
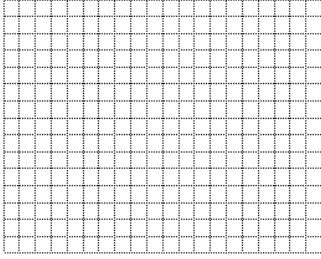

2. Aşağıdaki parçalarda eksik çizgi yada eksik görünüşleri tamamlayınız. Ölçülendirme yapmayınız. (50 p)

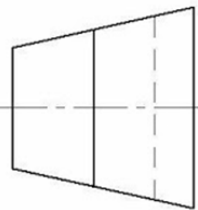
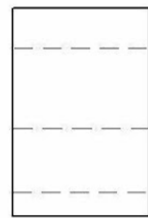
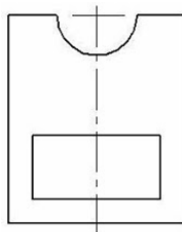
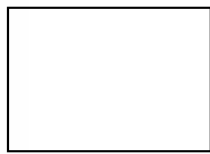
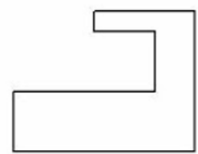
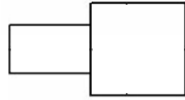
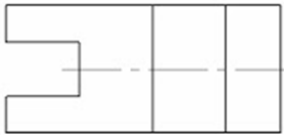
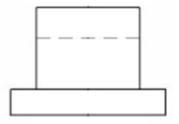
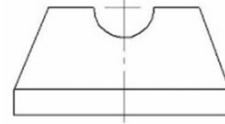
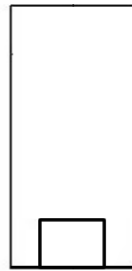
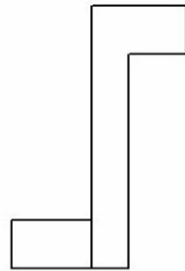
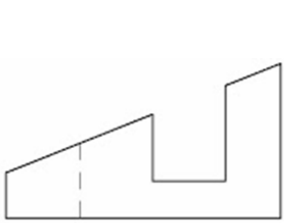

3. Aşağıdaki şekli saçtan üretebilmek için gerekli ölçüleri ve eksenleri çiziniz (10 p).

